

## TP-2732-KH•PH series [For intermittent operation]

Output[w] **0.8~3.5**

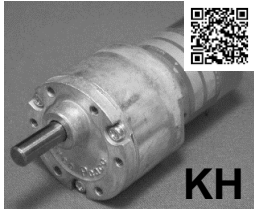

4-M3x0.5 TAPPED HOLE  
(3.5mmMAX) P.C.D#31

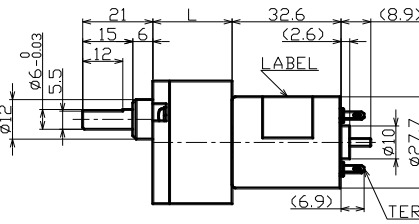
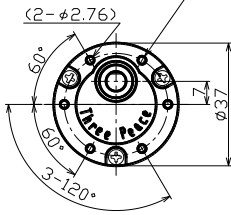

Gear ratio	1/5~1/900
Torque[mN·m]	7.84~588
Speed[r/min]	1,807~4.8
Voltage[V]	12 · 24

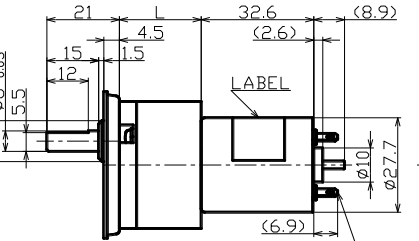
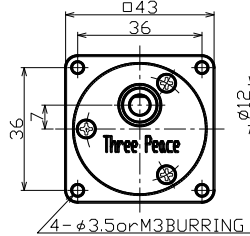
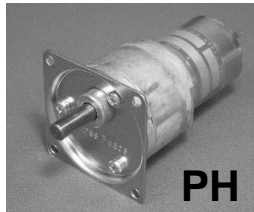

Unit [mm]

## TP-2732-KJ•PJ series [For endurance run]

Output[w] **0.8~3.5**

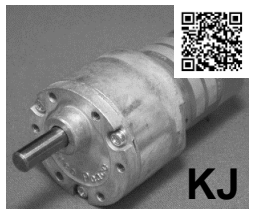

4-M3x0.5 TAPPED HOLE  
(3.5mmMAX) P.C.D#31

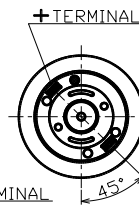
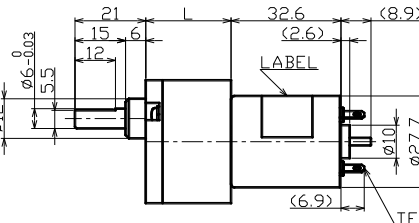
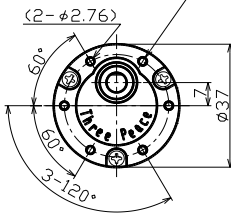

Gear ratio	1/5~1/900
Torque[mN·m]	78.4~588
Speed[r/min]	1,807~4.8
Voltage[V]	12 · 24

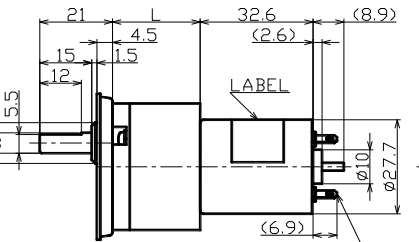
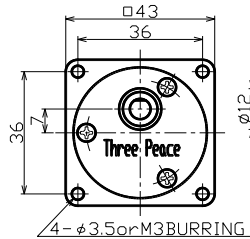
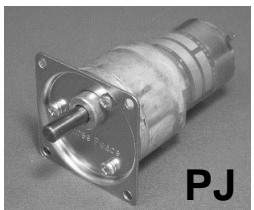

Unit [mm]

## TP-2732-KS•PS series [For intermittent operation • Sintering gear]

Output[w] **0.8~3.5**

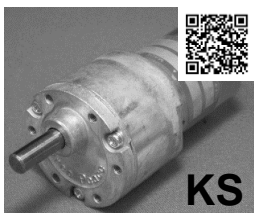

4-M3x0.5 TAPPED HOLE  
(3.5mmMAX) P.C.D#31

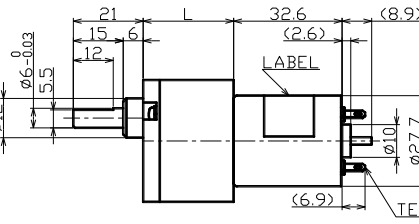
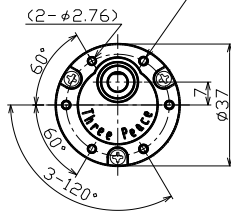

Gear ratio	1/10~1/900
Torque[mN·m]	9.8~588
Speed[r/min]	786~4.8
Voltage[V]	12 · 24

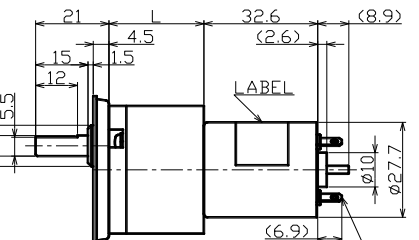
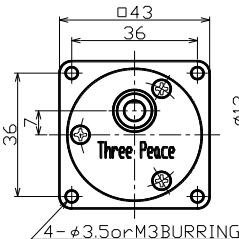
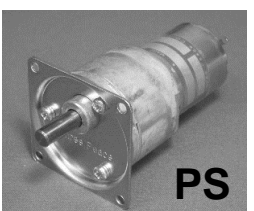

Unit [mm]